

**domicile**  
EXTENDED  
WARRANTY

THE DOMICILE EXTENDED WARRANTY IS A COMMITMENT TO OUR WORK, OUR TEAM AND MOST IMPORTANTLY OUR CUSTOMERS

A REMARKABLE 4-YEAR WARRANTY LIKE NO OTHER

THE SAME PROTECTION AS THE STANDARD WARRANTY, BUT FOR AT LEAST TWICE AS LONG

INCLUDED IN THE PRICE OF YOUR NEW HOME



A PROGRAM BY ENBRIDGE GAS DISTRIBUTION

- AN INTEGRATED DESIGN PROCESS WHERE BUILDING SCIENCE EXPERTS FROM ENBRIDGE AND DOMICILE'S DESIGN TEAM WORKED TOGETHER TO IDENTIFY THE OPTIMAL MIX OF DESIGN ELEMENTS AND TECHNOLOGIES TO MAXIMIZE THE ENVIRONMENTAL PERFORMANCE OF THIS PROJECT
- THE RESULT WILL BE A BUILDING WITH ENERGY SAVINGS THAT EXCEEDS THE ONTARIO BUILDING CODE BY AT LEAST 25%
- AFTER THE BUILDING IS COMPLETE, A COMMISSIONING REVIEW OF THE BUILDING IS CONDUCTED TO ENSURE ALL SYSTEMS AND TECHNOLOGIES ARE WORKING AS INTENDED

Actual usable space may vary slightly from stated floor area  
All dimensions are approximate E. & O.E.

# THE BELLWOOD

## WITH TERRACES

### 1195 sq.ft.



1 THE BELLWOOD  
T3.1

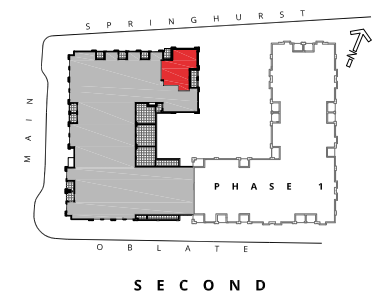

2 KEY PLAN  
T3.1

DESIGN NOTES/QUESTIONS:

- TWO TERRACES
- SEPARATE DINING AREA

# SUITES

## 202

FACTS:  
**TWO BEDROOM**  
SUITE AREA: 1195 sq.ft.  
TERRACE AREA: 208 sq.ft.  
TOTAL AREA: 1403 sq.ft.

- LEGEND:
- [Hatched Box] PARTY WALLS, INTERIOR/EXTERIOR WALLS AND PLUMBING WALLS
  - [Solid Black Box] STRUCTURAL ELEMENTS
  - [W/D Box] WASHER/DRYER
  - [W/D Box] COMBINATION WASHER/DRYER
  - [Square with X] HEAT PUMP/ HEAT RECOVERY VENTILATOR (HRV)
  - [Tub Icon] TUB
  - [Tub Icon] FREESTANDING TUB
  - [Shower Icon] SHOWER
  - [Vanity Icon] BATHROOM VANITY
  - [Sink Icon] PEDESTAL SINK
  - [Sink Icon] WATER CLOSET
  - [Sink Icon] SINGLE BOWL UNDERMOUNT KITCHEN SINK
  - [Sink Icon] DOUBLE BOWL UNDERMOUNT KITCHEN SINK
  - [Dishwasher Icon] DISHWASHER D24-24" WIDE D18-18" WIDE
  - [Cooktop Icon] COOKTOP WITH OVEN BELOW C30-30" WIDE C24-24" WIDE
  - [Refrigerator Icon] REFRIGERATOR F30-30" WIDE F24-24" WIDE
  - [P.] PANTRY
  - [LIN.] LINEN CLOSET
  - [M] MIRRORED PANEL DOOR
  - [Rod and Shelf Icon] DOUBLE ROD AND SHELF
  - [Rod and Shelf Icon] SINGLE ROD AND SHELF
  - [Tiled Floor Icon] TILED FLOOR 12" x 24"
  - [Window Icon] WINDOW
  - [Line Icon] PRIVACY SCREEN

**domicile**



DRAWING TITLE:  
**LAYOUT FEATURES**  
THE BELLWOOD

OPTION: STANDARD DATE: 2017.09.20

REV: 02 DRAWING NO. PHASE 2 T3.1